

frontek  
cerámica tecnológica en fachadas

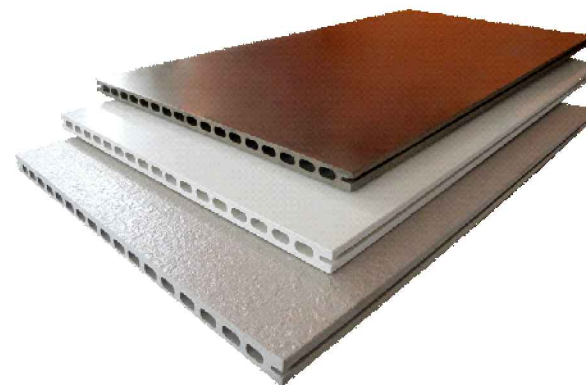

## FRONTEK ON PRECAST CONCRETE HORIZONTAL CONFIGURATION

---

FRONTEK AUSTRALIA PTY LTD.

[www.frontek.com.au](http://www.frontek.com.au)

+61 2 9316 6818

# Horizontal Configuration

STANDARD MODULE.

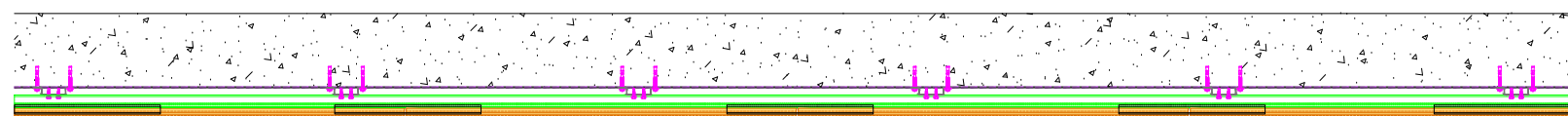
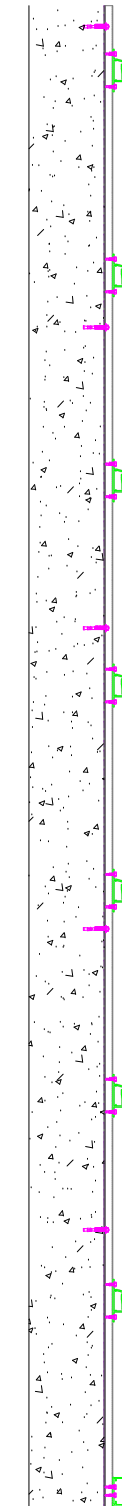
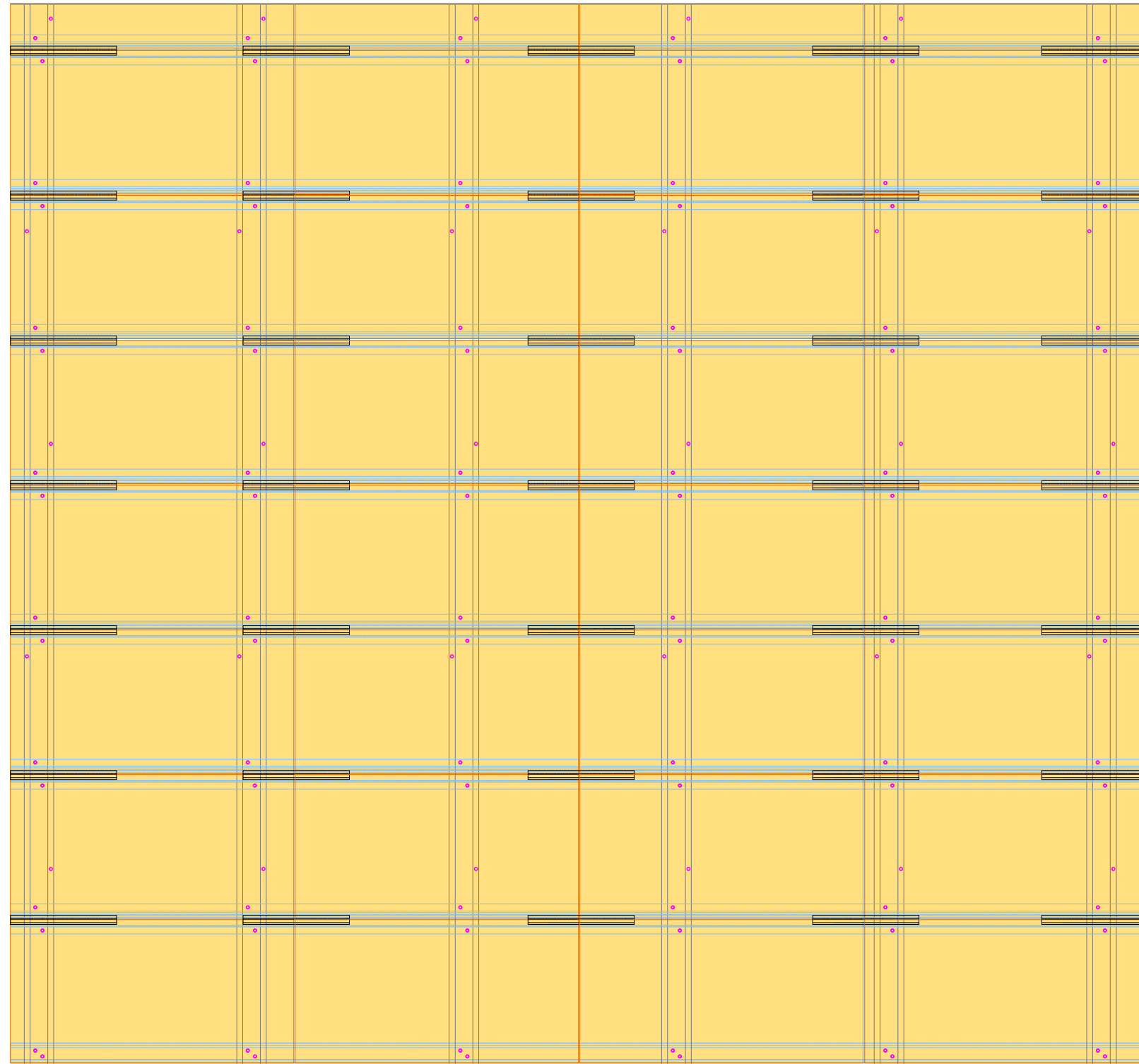

FOR INFORMATION

## COPYRIGHT

These designs, details and/or specifications and the Copyright Therein, remain the property of

**Frontek Australia.**

and shall not be divulged in any form whatsoever without written permission of

**Frontek Australia.**

All fixings sizes and types to be engineered by constructors

DRAWING DESCRIPTION  
HORIZONTAL CONFIGURATION  
STANDARD MODULE

SYSTEM  
-

DRAWN BY  
NURIA CASTRO

FIRST DRAWN DATE 31/01/2018

REVIEWED BY  
-

SCALE 1/150 SIZE A3

DRAWING NO. V600

**frontek**  
cerámica tecnológica en fachadas

FRONTEK AUSTRALIA PTY LTD.  
www.frontek.com.au  
+61 2 9316 6818

# Horizontal Configuration

VERTICAL SECTION.

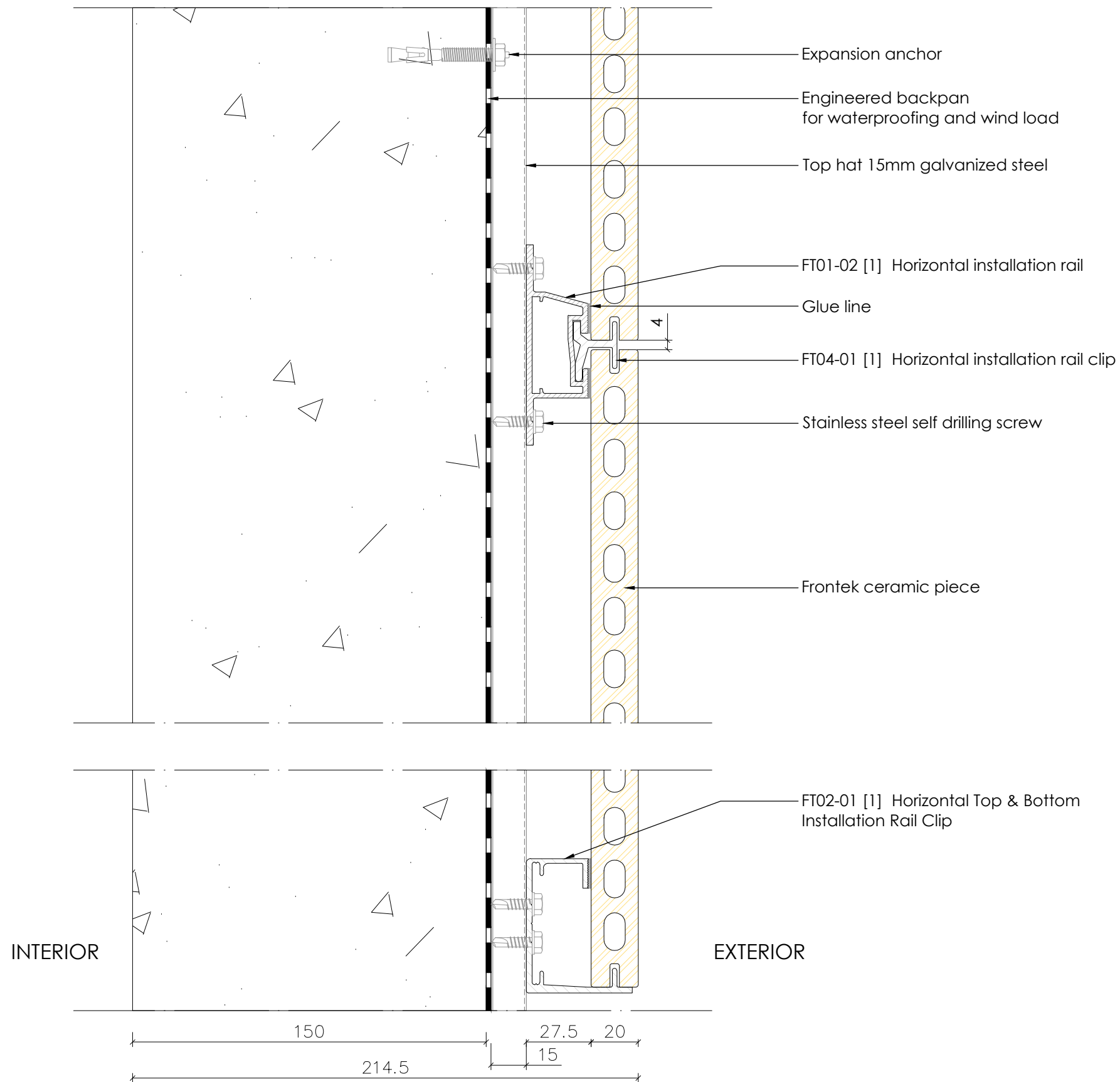

FOR INFORMATION

**COPYRIGHT**

These designs, details and/or specifications and the Copyright Therein, remain the property of

**Frontek Australia.**

and shall not be divulged in any form whatsoever without written permission of

**Frontek Australia.**

All fixings sizes and types to be engineered by constructors

DRAWING DESCRIPTION  
HORIZONTAL CONFIGURATION  
VERTICAL SECTION

SYSTEM  
-

DRAWN BY  
NURIA CASTRO

FIRST DRAWN DATE 31/01/2018

REVIEWED BY  
-

SCALE 1/20 SIZE A3

DRAWING NO. D601

**frontek**  
cerámica tecnológica en fachadas

FRONTEK AUSTRALIA PTY LTD.  
www.frontek.com.au  
+61 2 9316 6818

# Horizontal Configuration

## HORIZONTAL SECTION.

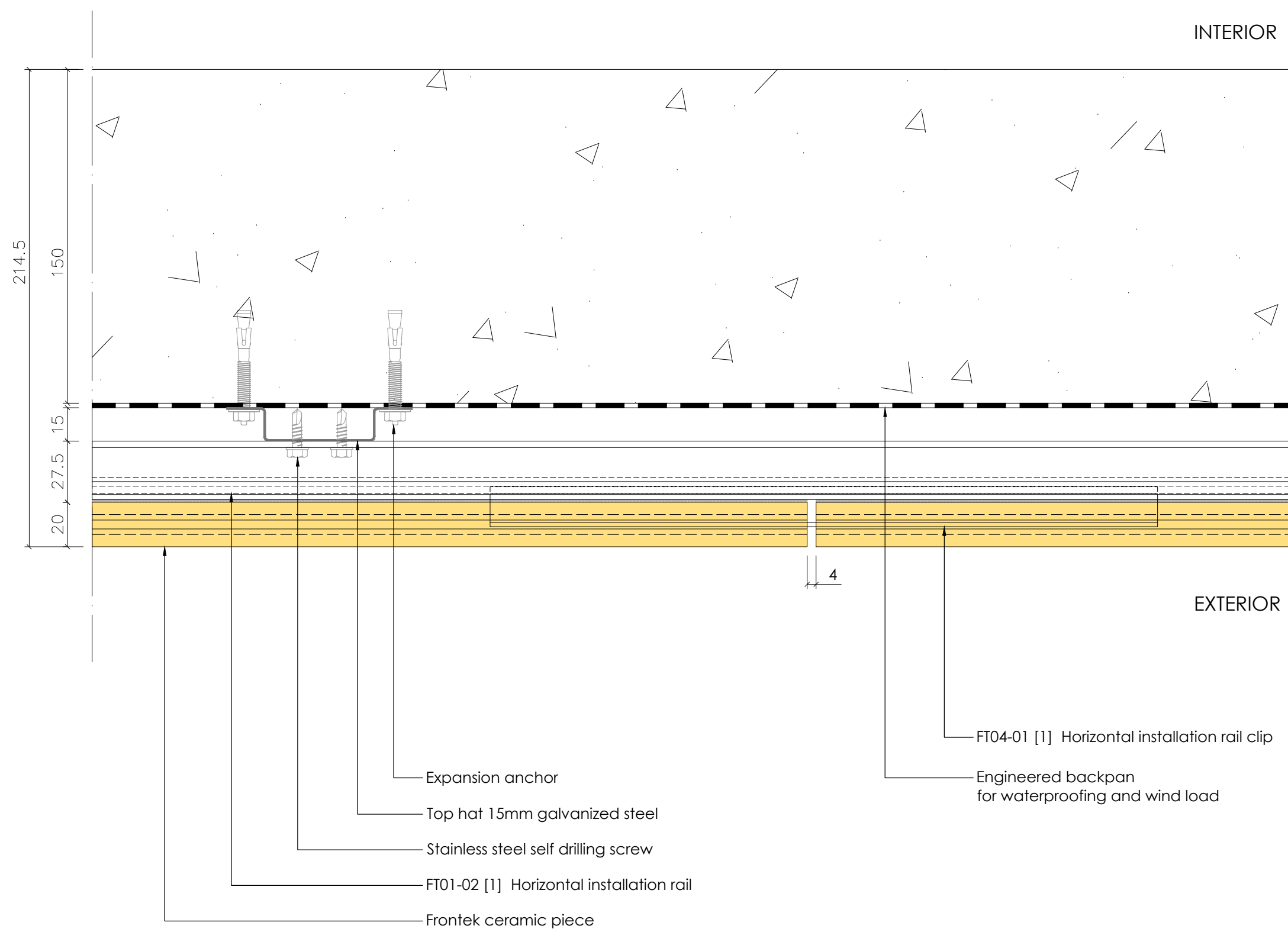

FOR INFORMATION

### COPYRIGHT

These designs, details and/or specifications and the Copyright Therein, remain the property of

**Frontek Australia.**

and shall not be divulged in any form whatsoever without written permission of

**Frontek Australia.**

All fixings sizes and types to be engineered by constructors

DRAWING DESCRIPTION  
HORIZONTAL CONFIGURATION  
VERTICAL SECTION

SYSTEM  
-

DRAWN BY  
NURIA CASTRO

FIRST DRAWN DATE 31/01/2018

REVIEWED BY  
-

SCALE 1/20 SIZE A3

DRAWING NO. D602

**frontek**  
cerámica tecnológica en fachadas

FRONTEK AUSTRALIA PTY LTD.  
www.frontek.com.au  
+61 2 9316 6818